

Type GS41 Series/ Surge Absorber

GS41系列/玻璃放电管

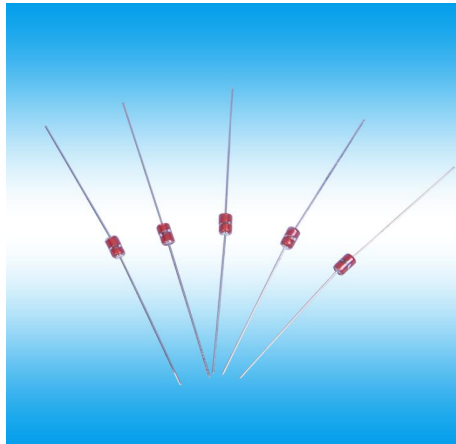

Features 产品特征

- Approximately zero leaking current before clamping voltage.  
箝位电压前泄漏电流近似为零。
- Less decay at on/off state.  
开关时态衰减减少
- High capability to withstand repeated lightning strikes.  
能承受多次闪电雷击
- Low electrode capacitance ( $\leq 0.5\text{pF}$ ) and high isolation ( $\geq 100\text{m}\Omega$ ).  
低电极电容 ( $\leq 0.5\text{pF}$ ) 和高隔离 ( $\geq 100\text{m}\Omega$ )
- Temperature, humidity and lightness insensitive.  
温度、湿度和亮度不敏感
- Bilateral symmetrical.  
双侧对称
- Operating temperature:  $-40^{\circ}\text{C} \sim +85^{\circ}\text{C}$   
工作温度:  $-40^{\circ}\text{C} \sim +85^{\circ}\text{C}$
- Storage temperature:  $-40^{\circ}\text{C} \sim +125^{\circ}\text{C}$   
储存温度:  $-40^{\circ}\text{C} \sim +125^{\circ}\text{C}$
- Meets MSL level1, per J-STD-020  
符合MSL一级, 符合J-STD-020

Applications 产品应用

- Power Supplies.  
电源
- High frequency signal transmitters/receivers.  
高频信号发射器/接收器
- Relay switching spark absorbing.  
继电器开关火花吸收
- Data line pulse guarding.  
数据线脉冲保护
- Electronic devices requiring UL497A and UL497B compliance.  
符合UL497A和UL497B标准的电子设备
- Telephone/Fax/Modem.  
电话/传真/调制解调器
- Motor sparks eliminating.  
电机火花消除
- Satellite antenna.  
卫星天线
- Radio amplifiers.  
广播功放
- Alarm systems.  
报警系统
- Cathode ray tubes in Monitors/TVS.  
射线管/监视器/电视

Dimensions(Unit:mm)尺寸(单位:mm)

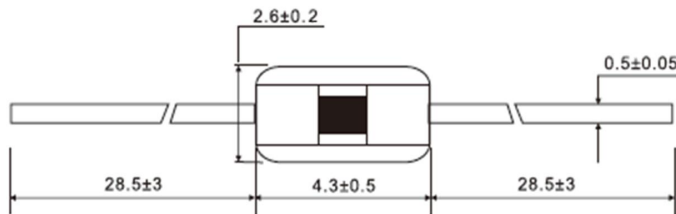

**Type GS41 Series/Surface Mounted Surge Absorber**

**Electrical Specifications 电气特性**

Catalog Number	DC Spark-Over Voltage 100V/s Vs(V)	Impulse Spark-Over 1KV/ μs	Nom Impulse Discharge Current 10×700μs(KV)	Nom Impulse Discharge Current 8×20μs(KA)	Insulation Resistance		Capacitance C 1MHz < 6V pF Max
					Min. M Ω	DC V	
GS41-141N	140V±30%	700	2.0	1.5	100	50	1
GS41-201M	200V±20%	700	2.0	1.5	100	100	1
GS41-301M	300V±20%	900	2.0	1.0	100	100	1
GS41-401M	400V±20%	1000	2.0	1.0	100	100	1
GS41-501M	500V±20%	1200	2.0	1.0	100	250	1
GS41-601M	600V±20%		2.0	1.0	100	250	1
GS41-102M	1000V±20%		2.0	1.0	100	250	1

**Packaging and Type Designation 包装和型号名称**

Symbol	Dimension (mm)
W	52±1.5
P	5.0±0.5
L1-L2	1Max
T	6.0±1.0
Z	1.2Max
R	Terminals must not project from tape
t	3.2Max
s	0.8Max
D1	φ0.5±0.05
L	4.8Max

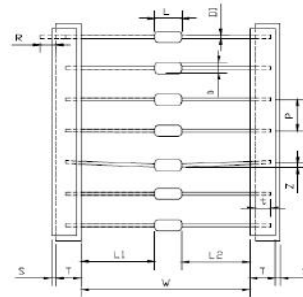

**Formation of Type Designation 类型命名的形成**

Example: GS41- 141 N  
① ② ③ ④

Symbols符合表

- ① GS: GLASS SURGE ABSORBER
- ② Series: GS51 GS41 GSMD DSL GSP
- ③ DC sparkover voltage marking: The first two number is significant digits, the last number is multiplier;
- ④ DC sparkover voltage tolerance: L: ±15% M: ±20% N: ±30%

On Taping: GS41 series-2000pcs Per Reel  
GS41 series -20000pcs outer box.

Type GS41 Series/Surface Mounted Surge Absorber

Recommended Soldering Conditions 焊接条件

Flow Soldering Conditions

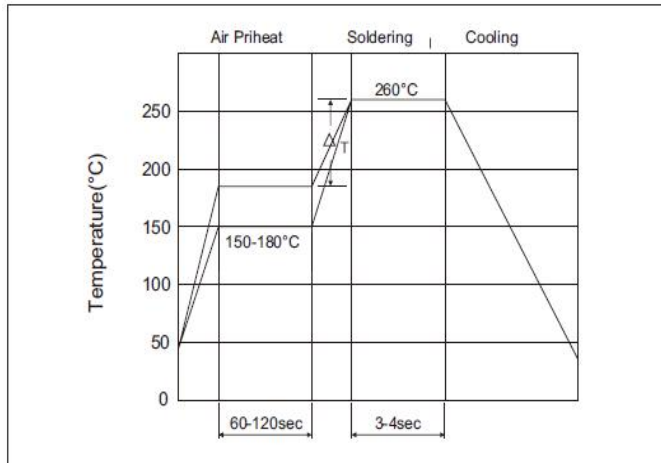

Reflow Soldering Conditions

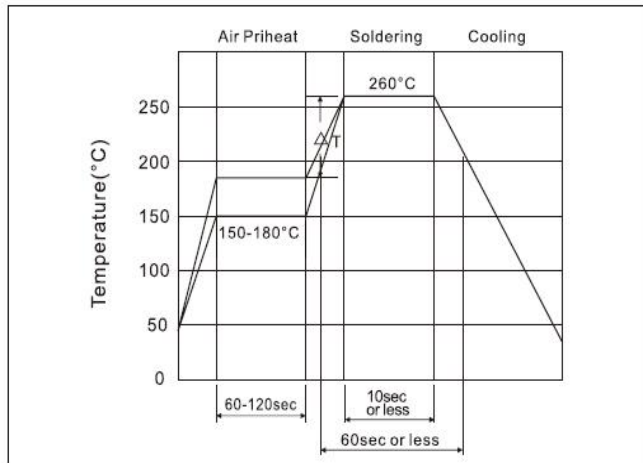

Hand Soldering

Solder iron temperature:  $350 \pm 5^\circ\text{C}$ .  
Heating time: 3 seconds max.

- Time shown in the above figures is measured from the point when chip surface reaches
- Temperature difference in high temperature part should be within  $110^\circ\text{C}$ .
- After soldering, do not force cool, allow the parts to cool gradually.